

You will be taking your AP Exam(s) next month. Prior to exams you should review the date(s) and time(s) of your AP Exams for accuracy. If you have any concerns, please contact Mrs. Veeseer or Ms. Allen **immediately**. Please also familiarize yourself with the testing location and parking prior to testing.

You should bring the following items to the exam room:

- A photo ID
- Several sharpened No. 2 pencils (with erasers) for completing multiple-choice answer sheets
- Pens with black or dark blue ink for completing areas on the exam booklet covers and for free-response questions in most exams
- A watch (in case your exam room does not have a clock that you can see easily)
- Up to two calculators with the necessary capabilities if you are taking an AP Calculus, Chemistry, Physics, or Statistics Exam. (Visit www.collegeboard.com/ap/calculators to learn more about the calculator policy for each of these exams, and for a list of authorized calculators.)
- A ruler or straightedge if you are taking an AP Physics Exam
- Your social security number for identification purposes (optional). If you provide it, the number will appear on your AP score reports.

You should not bring the following to the exam room:

- Cell phones, digital cameras, personal digital assistants (PDAs), Bluetooth-enabled devices, MP3 players, e-mail/messaging devices, or any other electronic or communication devices
- Books, compasses, mechanical pencils, colored pencils*, correction fluid, dictionaries, highlighters*, or notes
- Rulers and straightedges (except as noted above)*
- Scratch paper (notes can be made on portions of the exam booklets or, for Chinese Language and Culture and Japanese Language and Culture, on scratch paper provided by the proctor)
- Computers* or calculators (except as noted above)
- Reference guides, keyboard maps, or other typing instructions
- Watches that beep or have an alarm
- Portable listening* or recording devices (even with headphones) or photographic equipment
- Food or drink*
- Clothing with subject-related information

* Unless this has been pre approved as an accommodation by the College Board Services for Students with Disabilities office prior to the test date.

You are required to arrive at the testing site at : 7:15 a.m. for the morning administration and 11:15 a.m. for the afternoon administration.

We are testing at Oakland University, Stoney Creek and Hart Middle School this year. Please check carefully which building and room you will be testing in as they change daily. AP teachers have been provided rosters for all students to check their testing day, building and room number. If your test is located at Oakland University, please make sure to visit Oakland University prior to your testing day to ensure you know how to get to the building/classroom and understand the timing for parking and walking to the testing location.

Students may not be dismissed until an exam has officially ended. Do not ask to leave early if you finish before the end of the exam. If you play a sport or have a job, it is your responsibility to inform your coach or employer of your AP Exam obligation and make arrangements should be made accordingly.

Sending your scores to your chosen college:

Log into AP Classroom. When it prompts you to select where to send your scores, bypass this by clicking "I don't want to send my scores" UNLESS YOU ARE A SENIOR. Seniors, in My AP, click on My AP Profile in the blue section toward the right. Click on the Score Send. Indicate the college where you would like your scores to be sent. Click Save.

You are required to abide by the policies of both the College Board and Rochester Community Schools during the exam period. Any misconduct will be reported and could jeopardize your AP Exam score. Please note that you are not required to attend school on the day of your exam(s). An attendance roster will be published for the school letting them know who was there. Get a good night's rest before your exam, and eat a nutritious breakfast. You are allowed to bring a snack and beverage to the testing site for your 10-minute break. However, food and drink are prohibited in the exam room. It is advisable to bring a sweater in case the room temperature is below your comfort level.

Be sure to review the 2021-22 *Bulletin for AP Students and Parents* that you received in your AP class. If you have any additional concerns, please feel free to contact us. Good luck!

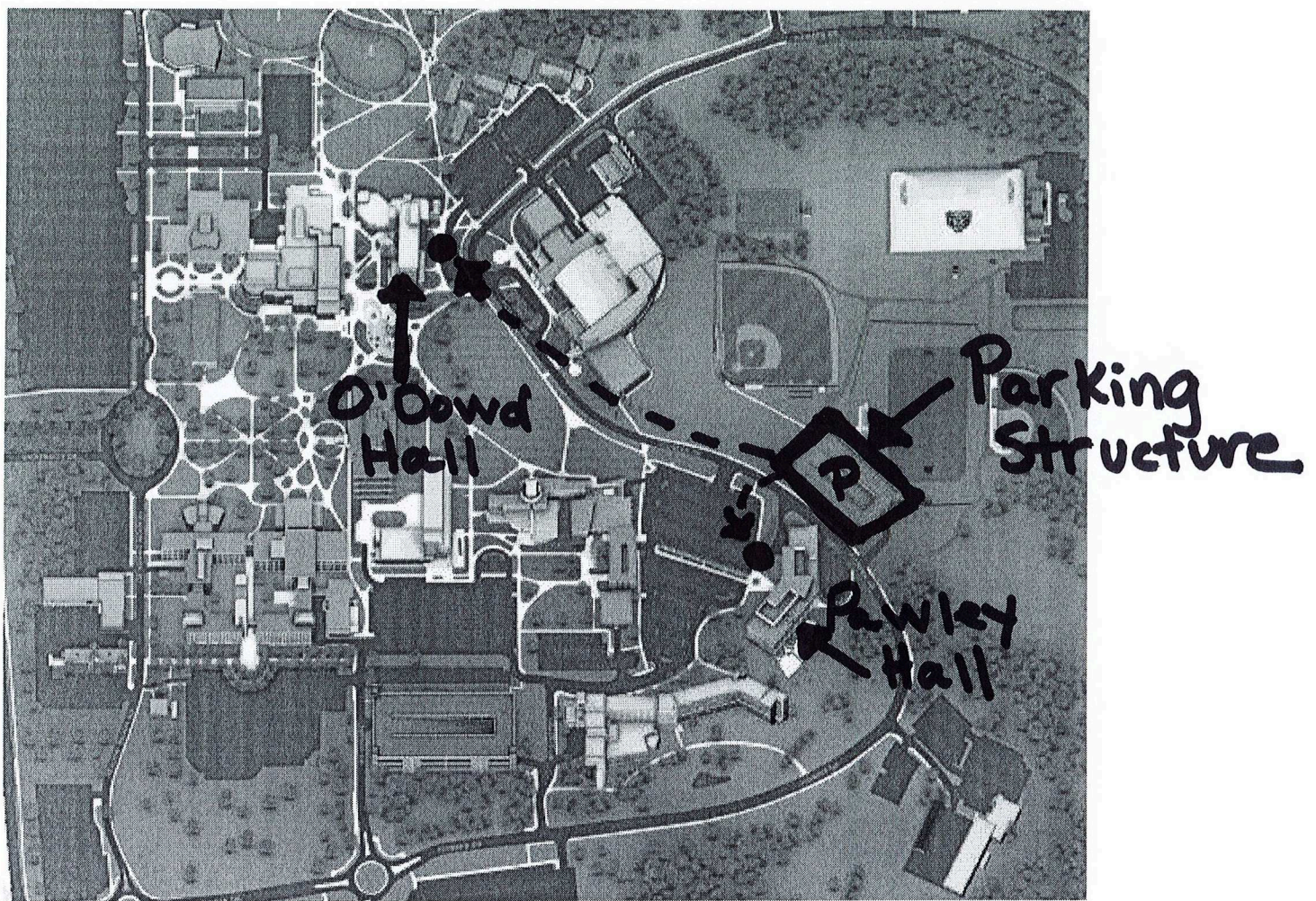

* Go to your building and the actual classroom BEFORE your testing day. Park in the structure and time your walk!

Be early!

HART MIDDLE SCHOOL

Student Drop-off Procedure

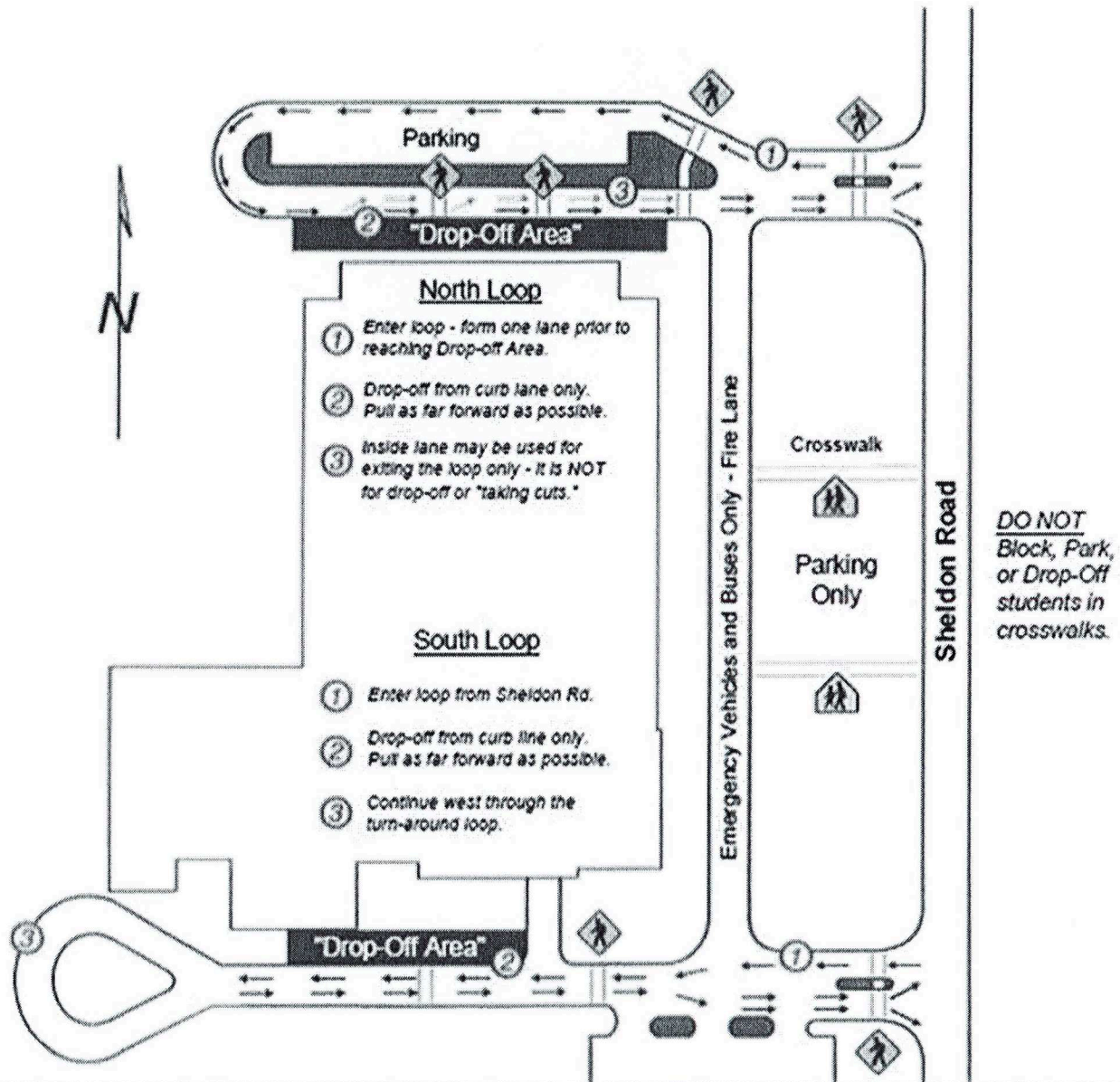

Remind codes to join for daily testing info:

Text 81010

Code

Last names A-C @aptestac

Last names D-J @aptestdj

Last names K- Me @aptestkme

Last names Mi -R @aptestmir

Last names S-Z @aptestsz

SCHS ONLY - AP Exam Information WEEK 1

DATE	REPORT TIME	EXAM	STUDENT LAST NAME	LOCATION
5/2	7:15 AM	AP Japanese	A - Z	SCHS Media Center - B252
5/2	7:15 AM	AP Government	A - Lee, D	SCHS - Aux Gym
5/2	7:15 AM	AP Government	Lee, K - Z	SCHS - Main Gym
5/2	11:15 AM	AP Chemistry	A - Z	SCHS - Aux Gym
5/3	7:15 AM	AP Environmental Science	A - Z	SCHS - Aux Gym
5/3	11:15 AM	AP Psychology	A - Ku	SCHS - Aux Gym
5/3	11:15 AM	AP Psychology	Kw - Z	SCHS - Main Gym
5/4	7:15 AM	AP Lit & Comp	A - Mah	OU - O'Dowd Hall 202A
5/4	7:15 AM	AP Lit & Comp	Mak - Z	OU - O'Dowd Hall 202B
5/4	11:15 AM	AP Computer Science A	A - Ko	OU - O'Dowd Hall 202A
5/4	11:15 AM	AP Computer Science A	Ku - Z	OU - O'Dowd Hall 202B
5/5	7:15 AM	AP Human Geography	A - Z	OU - O'Dowd Hall 202B
5/5	7:15 AM	AP Macroeconomics	A - Pi	OU - O'Dowd Hall 202A
5/5	7:15 AM	AP Macroeconomics	Po - Z	OU - O'Dowd Hall 202C
5/5	11:15 AM	AP Seminar	A - Kie	OU - Pawley Hall 307
5/5	11:15 AM	AP Seminar	Kim - Z	OU - Pawley Hall 308
5/5	11:15 AM	AP Statistics	A - G	OU - O'Dowd Hall 202A
5/5	11:15 AM	AP Statistics	H - Po	OU - O'Dowd Hall 202B
5/5	11:15 AM	AP Statistics	Pr - Z	OU - O'Dowd Hall 202C
5/6	7:15 AM	AP US History	A - Bara	Hart MS - A1
5/6	7:15 AM	AP US History	Barb - Car	Hart MS - A3
5/6	7:15 AM	AP US History	Cas - Cra	Hart MS - A4
5/6	7:15 AM	AP US History	Cro - Fl	Hart MS - A6
5/6	7:15 AM	AP US History	Fo - Han	Hart MS - A7
5/6	7:15 AM	AP US History	Har - Jag	Hart MS - A8
5/6	7:15 AM	AP US History	Jah - Kh	Hart MS - A9
5/6	7:15 AM	AP US History	Ki - Lin	Hart MS - A16
5/6	7:15 AM	AP US History	Lio - Mi	Hart MS - A17
5/6	7:15 AM	AP US History	Mo - Pa	Hart MS - A18
5/6	7:15 AM	AP US History	Pe - Ros	Hart MS - A19
5/6	7:15 AM	AP US History	Rou - So	Hart MS - A22
5/6	7:15 AM	AP US History	Sr - Vi	Hart MS - A26
5/6	7:15 AM	AP US History	Vo - Z	Hart MS - A27
5/6	11:15 AM	AP Microeconomics	A - Bro	Hart MS - A1
5/6	11:15 AM	AP Microeconomics	Bry - Do	Hart MS - A3
5/6	11:15 AM	AP Microeconomics	Du - He	Hart MS - A4
5/6	11:15 AM	AP Microeconomics	Ho - La	Hart MS - A6
5/6	11:15 AM	AP Microeconomics	Le - Monte	Hart MS - A7
5/6	11:15 AM	AP Microeconomics	Monto - Pillai	Hart MS - A8
5/6	11:15 AM	AP Microeconomics	Pillar - Scho	Hart MS - A9
5/6	11:15 AM	AP Microeconomics	Schu - Tand	Hart MS - A16
5/6	11:15 AM	AP Microeconomics	Tann - Z	Hart MS - A17
5/6	11:15 AM	AP Art History	A - Z	Hart MS - A22

SCHS ONLY - AP Exam Information WEEK 2

DATE	REPORT TIME	EXAM	STUDENT LAST NAME	LOCATION
5/9	7:15 AM	AP Calculus BC	A - Kim, Da	OU - O'Dowd Hall 202A
5/9	7:15 AM	AP Calculus BC	Kim, Do - Z	OU - O'Dowd Hall 202B
5/9	7:15 AM	AP Calculus AB	A - F	OU - Pawley Hall 307
5/9	7:15 AM	AP Calculus AB	G - Li	OU - Pawley Hall 308
5/9	7:15 AM	AP Calculus AB	Lo - Sm	OU - Pawley Hall 309
5/9	7:15 AM	AP Calculus AB	St - Z	OU - Pawley Hall 310
5/9	11:15 AM	AP Comp Sci Principles	A - E	OU - O'Dowd Hall 202A
5/9	11:15 AM	AP Comp Sci Principles	F - Naa	OU - O'Dowd Hall 202B
5/9	11:15 AM	AP Comp Sci Principles	Nal - Z	OU - O'Dowd Hall 202C
5/10	7:15 AM	AP Lang & Comp	A - DeM	OU - O'Dowd Hall 202A
5/10	7:15 AM	AP Lang & Comp	Den - H	OU - O'Dowd Hall 202B
5/10	7:15 AM	AP Lang & Comp	J - Li	OU - O'Dowd Hall 202C
5/10	7:15 AM	AP Lang & Comp	Lo - Mu	OU - Pawley Hall 307
5/10	7:15 AM	AP Lang & Comp	My - P	OU - Pawley Hall 308
5/10	7:15 AM	AP Lang & Comp	Q - Sch	OU - Pawley Hall 309
5/10	7:15 AM	AP Lang & Comp	Scr - U	OU - Pawley Hall 310
5/10	7:15 AM	AP Lang & Comp	V - Wong	OU - Pawley Hall 312
5/10	7:15 AM	AP Lang & Comp	Woo - Z	OU - Pawley Hall 318
5/10	11:15 AM	AP Physics C: Mechanics	A - Z	OU - O'Dowd Hall 202B
5/10	11:15 AM	AP Physics C: Elect. & Mag.	A - Z	OU - O'Dowd Hall 202B
5/11	7:15 AM	AP Chinese	A - Z	SCHS Media Center - B252
5/11	7:15 AM	AP Spanish	A - Z	SCHS - A234
5/11	11:15 AM	AP Biology	A - Hog	OU - O'Dowd Hall 202B
5/11	11:15 AM	AP Biology	Hon - M	OU - O'Dowd Hall 202A
5/11	11:15 AM	AP Biology	N - S	OU - O'Dowd Hall 202C
5/11	11:15 AM	AP Biology	T - Z	OU - Pawley Hall 307
5/11	11:15 AM	AP Biology	8 AP Spanish/AP Bio students	SCHS - A216
5/12	7:15 AM	AP French	A - Z	SCHS - A234
5/12	7:15 AM	AP World History	A - Z	RHS Media Center
5/13	7:15 AM	AP German	A - Z	SCHS - A234